



Front Doors

RD80/RD100





Your front door is a key element of your house façade. Every day you see, touch, and use it. Consequently, your door should complement the façade, be safe and secure whilst providing the very best insulation from the element's. High tech. finishes and the very best accessories should ensure maintenance free use.

Ryterna offer a wide range of made-to-measure front doors in numerous design choices including the possibility to create your individual / bespoke design. The latest technologies combined with the perfect design features ensure an outstanding appearance and performance.

'Ryterna Entry' is a part of the 'Ryterna Group' who have been manufacturing doors since 1993. With authorised dealers all over Europe and our own transport fleet we can provide the shortest possible lead times. Ryterna entrance doors are manufactured in a new efficient factory located in Kaunas, Lithuania. Sustainability in manufacture combined with the thermal performance of our products is central to our growth philosophy. Ryterna constantly seek for morally responsible and environmentally cleaner ways to improve in all areas of business.

www.ryternaentry.com



RD80/RD100 designs	4
RD80 features	30
Features	44
Locking systems	48
Handles	50
Glazing	52
Finger scanners	53
Colours	54
Side and top elements	55
RD80/RD100 standard designs	56
RD80/RD100 Exclusive designs	64







Design	1055
Model	RD80
Outside colour	TG68/80043 +corten image panel+glass
Handle	IH-ALU+LED+corten-1800
Escutcheon	ESC-3
Glazing	Tinted SGT



Design **804**
Model **RD100**
Outside colour **RAL7016 + Golden Oak**
Handle **H90WD/G-1200**
Escutcheon **ESC-3**
Glazing **Etched effect**
Applique **Inlaid stainless metal**
Decor **Carving**





Design **1041**
Model **RD80**
Outside colour **RAL7016 + wood image panel**
Handle **H90S40-1200**
Escutcheon **ESC-3**
Glazing **Etched effect**







Design **1020**
Model **RD80**
Outside colour **RAL7016 + corten image panel**
Handle **H90S40-1200**
Escutcheon **ESC-3**
Applique **Inlaid stainless metal**



Design **1001**

Model **RD80**

Outside colour **RAL7016 + concrete image panel**

Handle **IH-ALU+LED+concrete-500**

Escutcheon **ESC-3**

Applique **Inlaid stainless metal**





Design **705**
Model **RD100**
Outside colour **RAL7016**
Handle **H90RB-800**
Escutcheon **ESC-3**
Glazing **Etched effect**
Applique **Inlaid stainless metal+Golden Oak**
Decor **Carving**

Design **805**
Model **RD80**
Outside colour **RAL 9005 + Old Oak**
Handle **H90WD/O-1200**
Escutcheon **ESC-3**
Finger scanner **FSC3**
Applique **Inlaid stainless metal**
Glazing **Etched effect**



Design **641**
Model **RD80**
Outside colour **Tiger 29/71335**
Handle **H45R-1200**
Escutcheon **ESC-3**
Glazing **Patterned SGP**
Applique **Inlaid Golden Oak**



Design **601**
Model **RD80**
Outside colour **RAL7040**
Handle **H90S-800**
Finger scanner **FSC3**
Escutcheon **ESC-3**
Glazing **Etched effect**
Applique **Inlaid stainless metal**

Design **652**
Model **RD80**
Outside colour **PP300/Black pearl**
Handle **H90S-800+LED**
Escutcheon **ESC-3**
Glazing **Tinted SGT**
Applique **Inlaid stainless metal**



Design **654**
Model **RD80**
Outside colour **TG68/80043**
Handle **H90R-1800**
Escutcheon **ESC-3**
Glazing **Etched effect**
Applique **Inlaid stainless metal**



Design **639**
Model **RD80**
Outside colour **Anthracite TG68/80043**
Handle **H90S40-800**
Escutcheon **ESC-1**
Glazing **Matt SGM**
Applique **Inlaid stainless metal**

Design **702**
 Model **RD80**
 Outside colour **RAL9007**
 Handle **H90S-1200**
 Escutcheon **ESC-3**
 Glazing **Etched effect**
 Applique **Inlaid stainless metal**
 Decor **Carving**



Design **801**
 Model **RD80 flush**
 Outside colour **RAL7040 +RAL9016**
 Handle **H90S40B-500**
 Escutcheon **ESC-3**
 Glazing **Matt SGM**
 Applique **Inlaid stainless metal**
 Decor **Carving**



Design	207
Model	RD100
Outside colour	RAL8007
Handle	H90R-1200
Escutcheon	ESC-3
Glazing	Clear SGC
Applique	Inlaid painted



Design **208**
Model **RD100**
Outside colour **Anthracite TG68/80043**
Handle **H90R-1600**
Escutcheon **ESC-3**
Glazing **Matt SGM**
Applique **Inlaid stainless metal**



Design **207**
Model **RD100**
Outside colour **RAL 8007 mat**
Handle **H90R-1200**
Finger scanner **FSC3**
Escutcheon **ESC-2**
Glazing **Matt SGM**
Applique **Inlaid stainless metal**
Kick plate **Smooth**



Design **704**
Model **RD100**
Outside colour **RAL9016**
Handle **H90RB-1400**
Escutcheon **ESC-3**
Glazing **Custom etched effect**
Applique **Inlaid stainless metal**
Decor **Carving**

Design **703**
 Model **RD100**
 Outside colour **Anthracite TG68/80043 + RAL9016**
 Handle **H90RB-1600**
 Escutcheon **ESC-3**
 Glazing **Etched effect**
 Applique **Inlaid stainless metal**
 Decor **Carving**



Design **Individual**
 Model **RD80**
 Outside colour **Anthracite TG68/80043**
 Handle **H90R-1600**
 Escutcheon **ESC-1**
 Glazing **Etched effect**
 Applique **Inlaid stainless metal**



Design **701**
Model **RD80**
Outside colour **RAL9016**
Handle **H45R-800**
Escutcheon **ESC-3**
Glazing **Matt SGM**
Applique **Inlaid stainless metal**
Decor **Carving**

Design **655**
 Model **RD80**
 Outside colour **RAL9016**
 Handle **H90S-1800**
 Finger scanner **FSC3**
 Escutcheon **ESC-3**
 Applique **Inlaid stainless metal**
 Glazing **Clear SGC**



Design **653**
 Model **RD80**
 Outside colour **RAL9001**
 Handle **H90R-1600**
 Escutcheon **ESC-3**
 Glazing **Etched effect**
 Applique **Inlaid stainless metal**



Design **615**
Model **RD80**
Outside colour **RAL7016**
Handle **H90S40-800**
Escutcheon **ESC-3**
Glazing **Matt SGM**
Applique **Inlaid stainless metal**

Design **650**
Model **RD80**
Outside colour **RAL7012**
Handle **H45R-500**
Escutcheon **ESC-3**
Finger scanner **FSC3**
Glazing **Matt SGM**
Decor **Carving**



Design **615**
Model **RD80**
Outside colour **RAL4004**
Handle **H45R-500**
Escutcheon **ESC-3**
Glazing **Matt SGM**
Applique **Inlaid stainless metal**





Design **907**
Model **RD80**
Outside colour **RAL 9016+RAL4004**
Handle **H45R-1600**
Escutcheon **ESC-2**
Glazing **Tinted SGT**
Applique **Inlaid stainless metal**

Design **630**
Model **RD80**
Outside colour **RAL-9016**
Handle **H90R-1200**
Escutcheon **ESC-3**
Glazing **Patterned SGP**
Applique **Inlaid stainless metal**



Design **603**
Model **RD80**
Outside colour **RAL9016**
Handle **H45R-500**
Escutcheon **ESC-1**
Glazing **Matt SGM**
Applique **Inlaid stainless metal**



Design	657
Model	RD80
Outside colour	Golden Oak
Handle	H90S-500
Escutcheon	ESC-3
Glazing	Etched effect
Applique	Inlaid stainless metal





Design **Individual**
Model **RD100**
Outside colour **RAL7016+RAL3005**
Handle **H90S40B-800**
Escutcheon **ESC-3**
Windows **Matt SGM**
Applique **Inlaid stainless metal**





Design	643*
Model	RD100
Outside colour	RAL7016
Handle	HRB-800
Escutcheon	ESC-3
Glazing	Matt SGM
Applique	Inlaid stainless metal





Design **Individual**
Model **RD100**
Outside colour **RAL7016**
Handle **H90R-1400**
Escutcheon **ESC-3**
Glazing **Clear SGC**
Applique **Inlaid stainless metal**





Design **910**

Model **RD100**

Outside colour **Tiger 29/90147/Tiger 29/60740**

Handle **HS-1000**

Escutcheon **ESC-3**

Glazing **Custom etched effect**

Applique **Inlaid stainless metal**





Design **Individual**
Model **RD100**
Outside colour **RAL7040**
Handle **HLS04**
Glazing **Tinted SGT**
Applique **Inlaid stainless metal**





Design	909
Model	RD100
Outside colour	RAL7016+RAL9016
Handle	H90RB-1400
Escutcheon	ESC-3
Glazing	Etched effect
Applique	Inlaid stainless metal
Kick plate	Smooth



The door frame is constructed from aluminium profiles including a thermal break to reduce thermal transference from the outer to inner skin. The doors leaf's inner and outer skins are created from a single sheet 2.5 mm thick aluminium sheets (some designs may differ).

The doors inner core, assembly profiles and frames are filled with a strong environmentally friendly freon free PU foam.

Triple all round perimeter rubber weather sealing completes a combination that gives Ryterna entrance doors the following performance values:

RD80

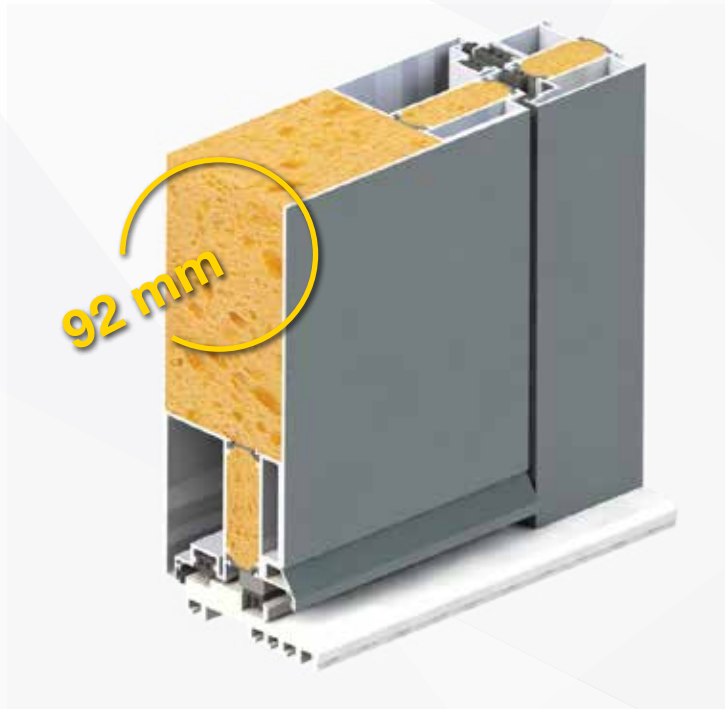

Ryterna entrance doors are made to resist the elements and certified by IFT testing institute in Rosenheim, Germany.

Thermal transmittance
U value



0.69 W/m²K

Safety resistance class
EN 12519



RC 3*

Wind resistance class
EN 12207:199-11



3

Rain resistance class
EN 12208:199-11



6A

Sound reduction
EN 717-1:2013



-32 Db

* RC2 as standard - RC3 option upgrade

A high quality durable magnetic 'pop-up' threshold is supplied with all RD80 & RD100 doors. Opening into the building and out are available.

All windows and sidelights are triple glazed with safety glass. Many decorative glass options are available including bespoke / custom engraving. Individual design elements can be added to complete your bespoke / custom doors.

All doors are made to order up to 1250mm wide & 2250mm high. For larger sizes consult manufacturer for feasibility.

RD100

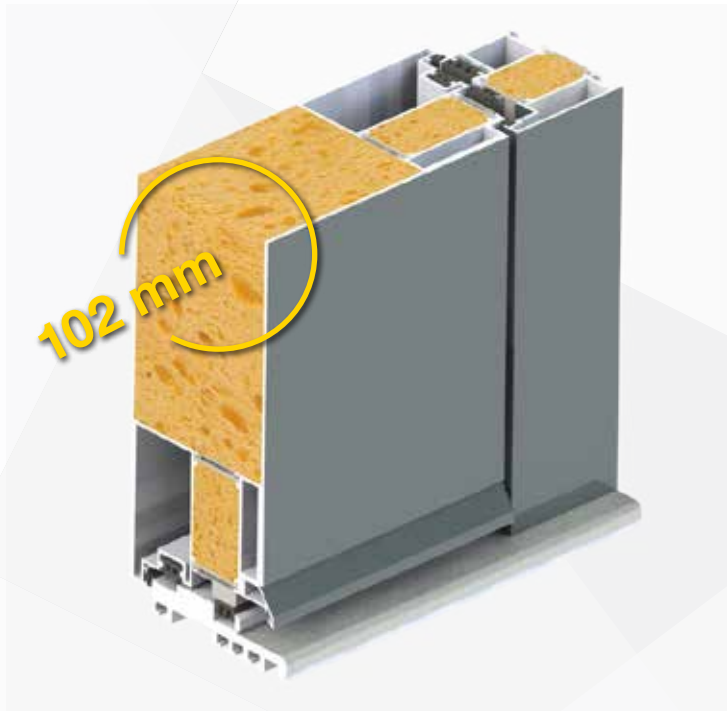

RC 3



Ryterna entrance doors are made to resist the elements and certified by IFT testing institute in Rosenheim, Germany.

Thermal transmittance

U value



0.65 W/m²K

Safety resistance class

EN 12519



RC 3*

Wind resistance class

EN 12207:199-11



3

Rain resistance class

EN 12208:199-11



6A

Sound reduction

EN 717-1:2013



-32 Db

* RC2 as standard - RC3 option upgrade

✓ Two types of frames

1. Flat
2. Jutted

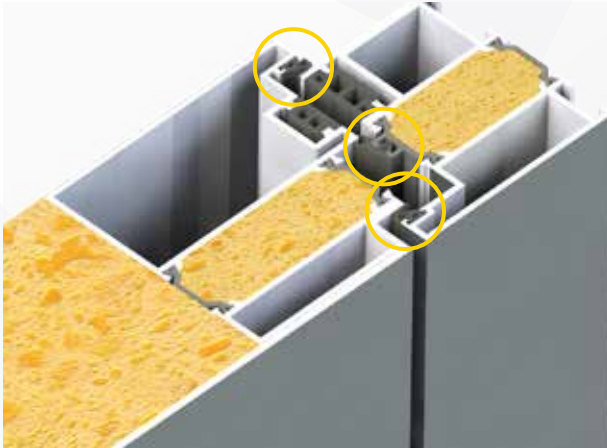

✓ Door leaf

Flush leaf with aluminium sheet skin.

✓ Magnetic threshold

The 'pop-up' magnetic strip is a high quality durable and maintenance free threshold system that significantly improves insulation and draughts. Two further rubbers ensure the best possible performance.

As the door closes a magnetic strip rises to create a perfect seal between the threshold and door. As the door opens the strip gently drops back into its groove reducing the step.

Our magnetic threshold has been designed to reduce the obstacles met by wheelchairs, prams and other wheeled vehicles.

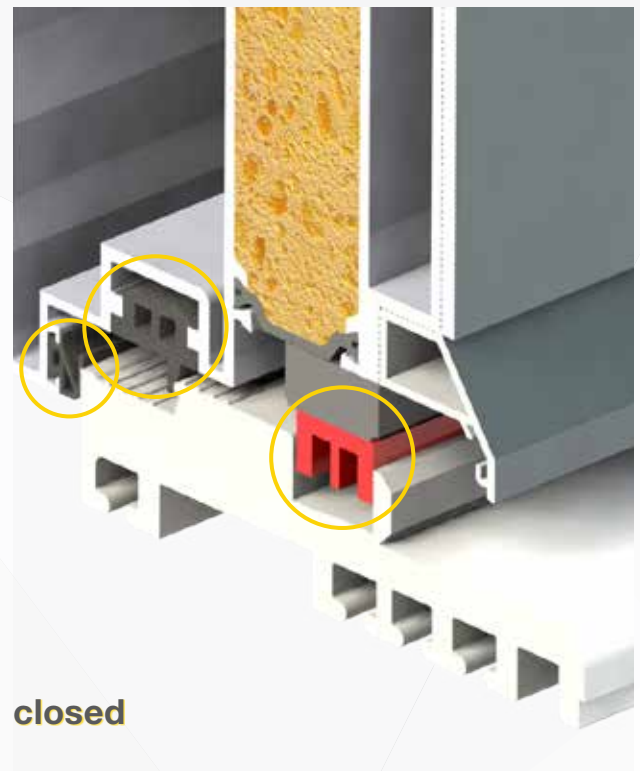

✓ Add-on bottom profiles

Available heights:
20 mm, 58 mm and 125 mm

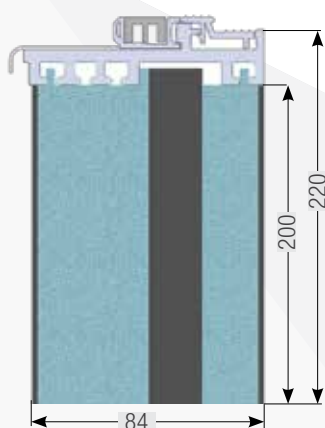
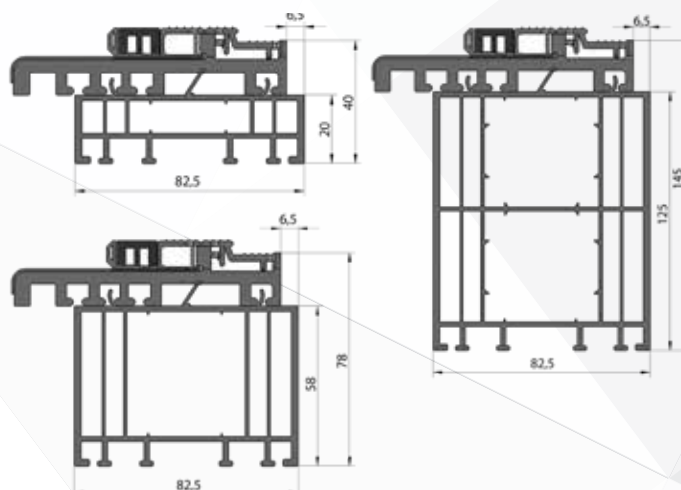

✓ Add-on bottom thermo profiles

Minimum height: 25 mm
Maximum height: 200 mm

✓ Key cylinders (safety classes A,B,C)

WILKA lock cylinders are famous for their security and quality. You can choose one of three security classes: A, B or C. With C been the highest. 5 keys are supplied with all WILKA cylinders.



CWA



CWA+TT

✓ Partial opening lock

Available in Silver or white.



POL

✓ Locks

KFV locks are made from high-quality materials with precise workmanship.

Hi-tech mechanics ensure reliable, precise and easy operation. Lots of options starting from the simplest 3 point lock up to sophisticated 5 point lock.

KFV



✓ 3 points multiple lock **L3P**

Main lock deadbolt and hook bolts operated by the key.

✓ 5 points multiple lock **L5P**

Two round latch bolts lock the leaf on closure automatically and opens by the key. Deadbolt and hook bolts operated by the key.

✓ Day & Night **L3P+D&N**

3 point multi-point lock with option to temporary disable self-locking. Main deadbolt and hook bolts operated by the key.

✓ Electric 1 **L3P+D&N+EM**

3 point multi-point lock with electric latch and option to temporary disable self-locking. Main lock deadbolt and hook bolts operated by the key.

✓ Electric 2 **L5PMA**

5 point multi-point lock.

Round latch and hook bolts lock the leaf on closure automatically. Deadbolt operated by the key only. If deadbolt is engaged automatic unlocking is disabled.

All latches open by electric drive when turning the key or pressing lever handle.

Lock can be connected to finger-scanner or keypad (optional).

Not compatible with lever handle from outside, pull handle only.

✓ Electric 3 **L5PM (without electric motor)**

5 point multi-point lock.

Round latch and hook bolts lock the leaf on closure automatically. Deadbolt operated by the key only.

All latches and deadbolt are unlocked by pressing inside handle.

Not compatible with lever handle from outside, pull handle only.

✓ Electric 4 **L5PA**

5 point multi-point lock with all latches and deadbolt operated by electric drive. Locks automatically when closing the door. All latches and deadbolt open by electric drive when turning the key or pressing lever handle. Not compatible with lever handle from outside, pull handle only. Lock can be connected to finger-scanner and keypad (optional)

✓ Electric 5 **L5P + panic function**

5 point multi-point lock.

Round latch bolts and hook bolts lock the leaf on closure automatically. Deadbolt is locked by the key.

All latches and deadbolt are unlocked by pressing inside handle.



L3P



L5P



L3P+D&N



L3P+D&N+EM



L5PMA



L5PM

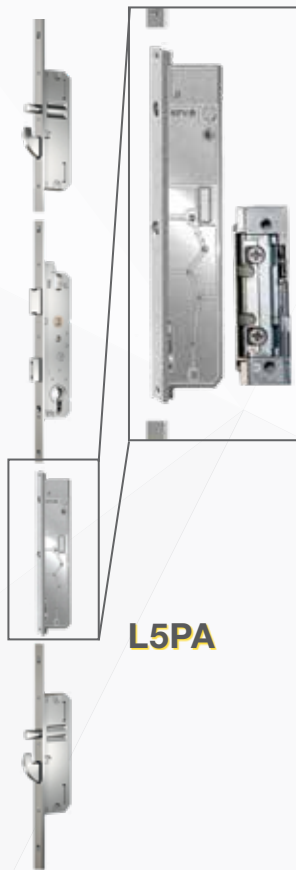

L5PA



**L5P+
panic
funktion**

✓ Escutcheons

You can choose from five stainless steel escutcheons.

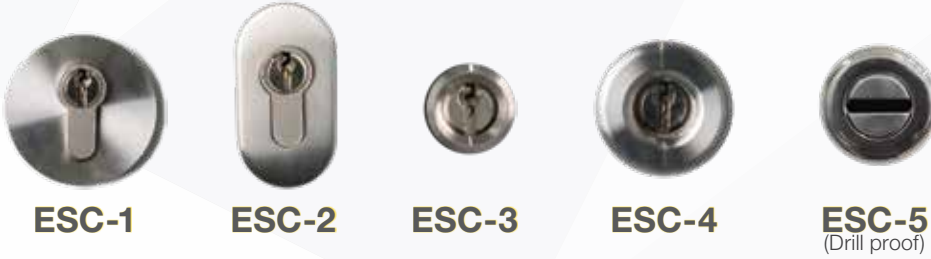

✓ Stainless steel pull handles





HS

Height available:
1000 mm



H90WD

Heights available:
800 mm
1200 mm
Colours available:
Gold Oak
Old Oak



IH

Size available:
(500x130 mm)



IH-ALU

Sizes available:
500 mm 1400 mm
800 mm 1600 mm
1200 mm 1800 mm



Lever and knob handles



HL-W (White)



HL-B (Black)



***HK-W** (White)



***HK-B** (Black)



HLA (Aluminium)



HLS 01 (Stainless steel)



HLS 02 (Stainless steel)



HLS 03 (Stainless steel)



HLS 04 (Stainless steel)



HLS 05 (Stainless steel)



HLS 06 (Stainless steel)



***HLS 07** (Stainless steel)



HLS 10 (White)



HLS 11 (Aluminium)



HLS 12 (Stainless steel)

*In pairs only (inside/outside).



✓ Triple safety glazing

Triple glazing on door leaves and side elements. Safety glass P4A outside and inside.

✓ Keypads

EKEY keypads are secure and easy to operate.

Up to 99 individual users.

The Keypad can be installed on door leaf or on the wall.

Ekey White



KP2

Ekey Black



KP3

✓ Ekey Arte FSC1

Thanks to its compact design Arte finger scanner can be integrated discreetly into unusual door designs and fittings.

✓ Ekey Integra FSC2

The finger scanner is mounted in the wall using stainless-steel accessories (in-wall set).

The finger scanner will only operate when connected to an ekey control panel.

Both finger-scanners can be controlled by app. So you can open the door with your smart-phone and enjoy all the benefits of operation via app.



FSC1



FSC2

✓ Sommer finger scanner FSC3

Secure and easy to operate Sommer finger scanners Increase key free security and convenience.

*Each user can enter three separate fingerprints to control your entrance door, garage door and gates. One simple swipe opens or closes your devices as desired.

✓ Sommer remote handset RMT1

Sommer handsets and fingerprint scanner are compatible with each other.

*The 4-channel handset can operate up to 4 devices including your entrance door, garage door, gates or even outside lights.

The Secure rolling code handset signal cannot be copied / cloned. More key free convenience with a quality designed handset.

*Other devices must be compatible or fitted with secondary receivers.



FSC3



RMT1

✓ Inside RAL colours

- RAL 9016 gloss 20%
- Any colour from Ryterna official RAL palette

Standard colours

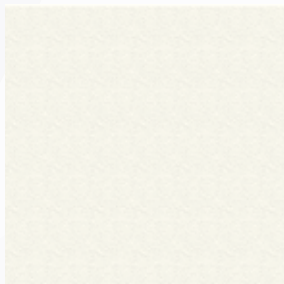

RAL 9016

Custom colours



Ryterna RAL palette

✓ Outside RAL colours

- RAL 9016 gloss 20%
- RAL 7016 gloss 20%
- RAL 7016 structure
- Anthracite TG68/80043
- Any colour from Ryterna official RAL palette

Standard colours

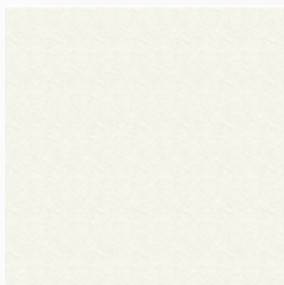

RAL 9016

Custom colours

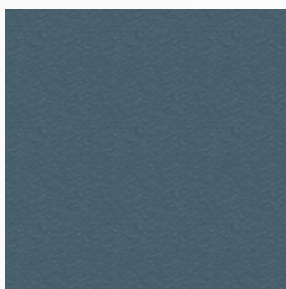

RAL 7016



**RAL 7016
structure**



**Anthracite
TG68/80043**



Ryterna RAL palette

✓ Side and top elements

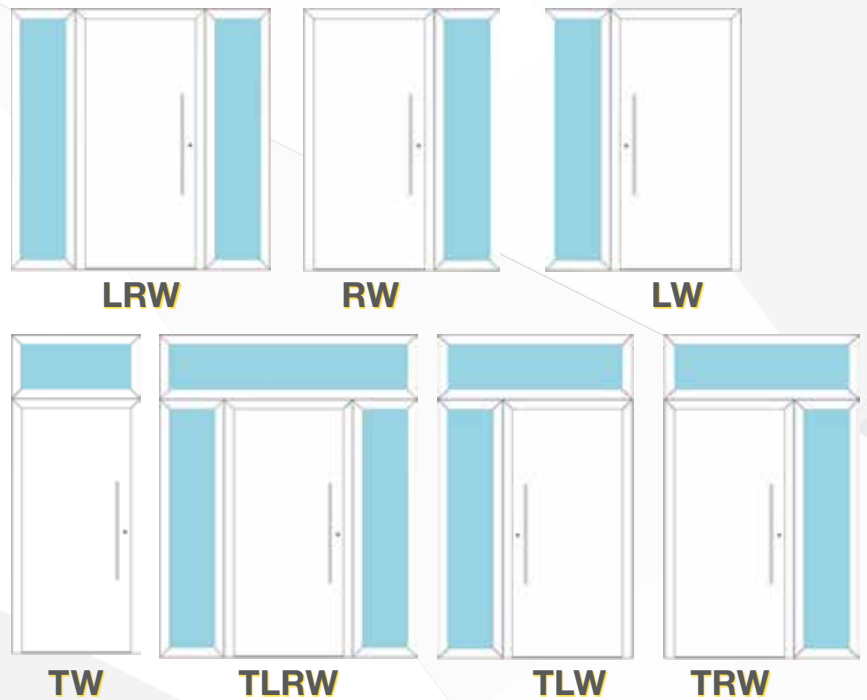
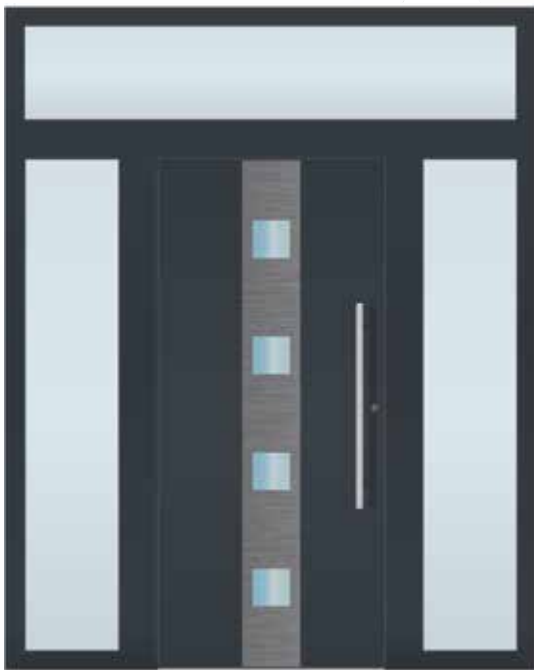

✓ Glazing options

STANDARD



Clear **SGC**

Matt **SGM**

Patterned **SGP**

NON-STANDARD



Similar to Delta Nr. 121

Chinchilla

Kathedral Klein

Similar to Silvit Nr. 118

Crepi

Tinted **SGT**

✓ Etched effect glazing

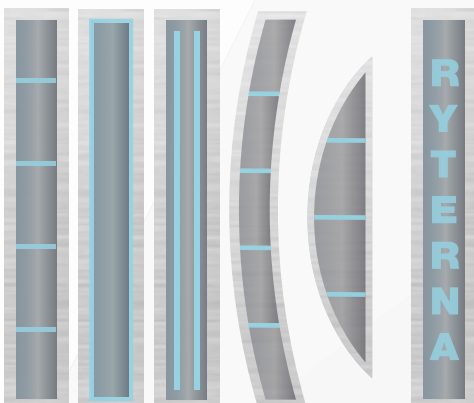

For design possibilities and price consult the manufacturer.



200



201



202



203



204



205



206



207



208



301



302



303



304



305



306



Stainless metal with brushed surface finish

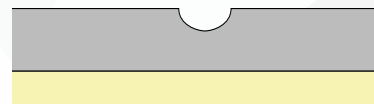
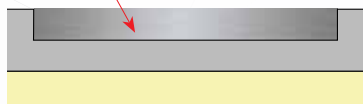

Inlaid stainless metal appliqué

Carving



307



308



309



310



311



312



313



314



315



316



317



401

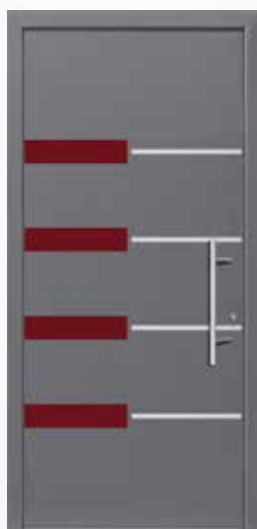

402



501



502



503



504



505



506



507



508



509



510



511



512



601



602



603



604



605



606



607



608



609



610



611



612



613



614



615



616



617



618



619



620



621



622



623



624



625



626



627



628



629



630



631



632



633



634



635



636



637



638



639



640



641



642



643



644



645



646



647



648



649



650



651



652



653



654



655



656



657



701



702



703



704



705



706

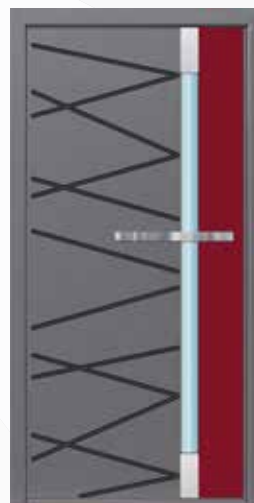

801



802

* you can modify existing or create your own door design



803



804



805



901



902

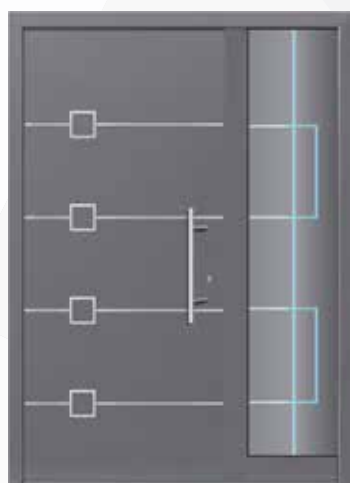

903

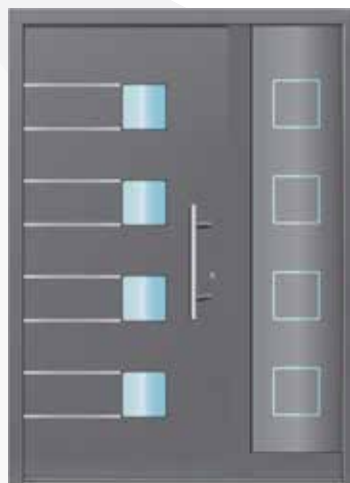

904



905

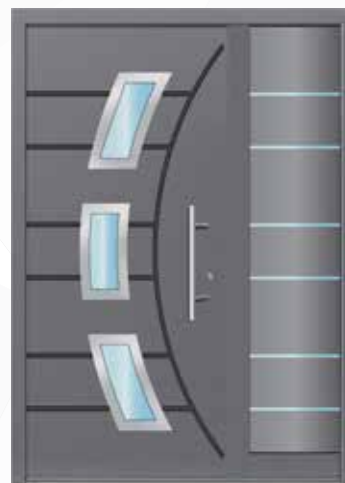

906

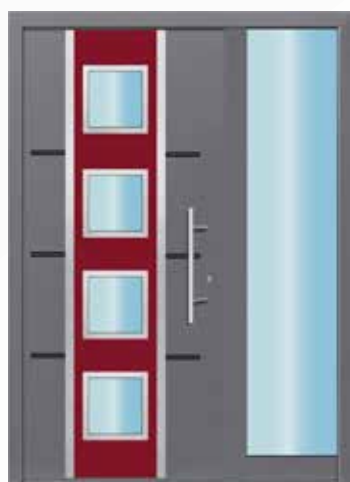

907

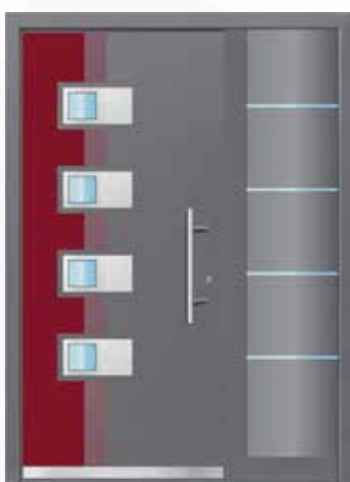

908

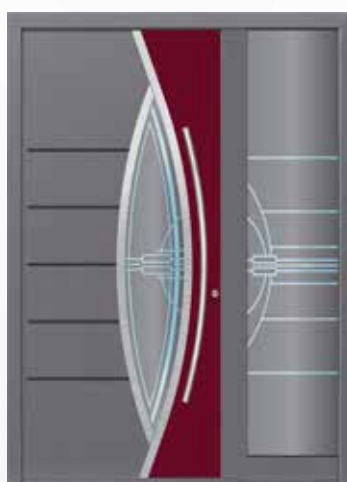

909



910



1000 concrete



1001 concrete



1002 concrete



1003 concrete



1004 concrete



1005 concrete



1006 concrete



1007 concrete



1008 concrete



1009 concrete

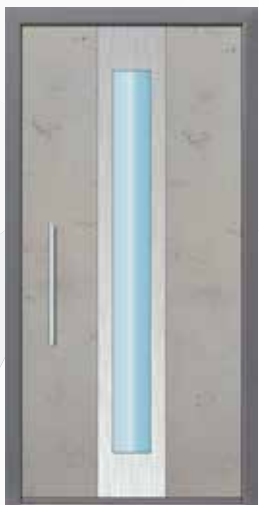

1010 concrete



1011 concrete

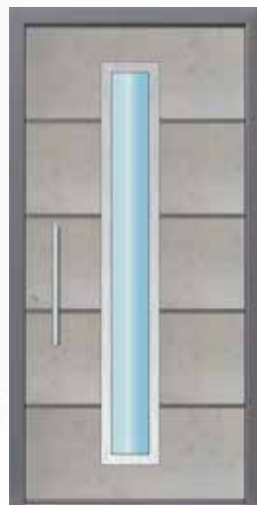

1012 concrete



1020 corten



1021 corten

* you can modify existing or create your own door design



1022 corten



1023 corten



1024 corten



1025 corten



1026 corten



1027 corten



1028 corten

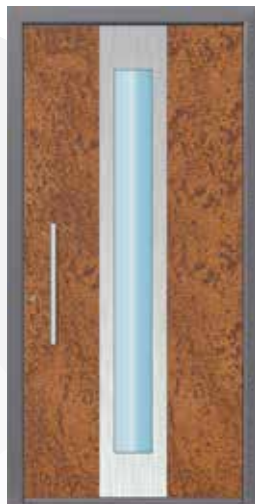

1029 corten



1030 corten

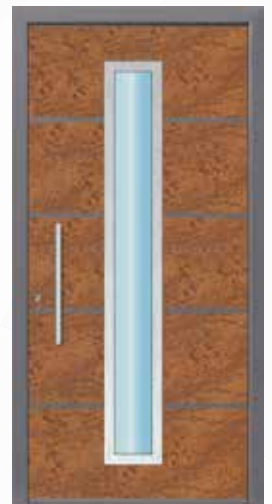

1031 corten



1032 corten



1040 wood



1041 wood



1042 wood



1043 wood



1044 wood



1045 wood



1046 wood



1050 glass



1051 glass



1052 glass



1053 glass



1054 glass



1055 glass+corten

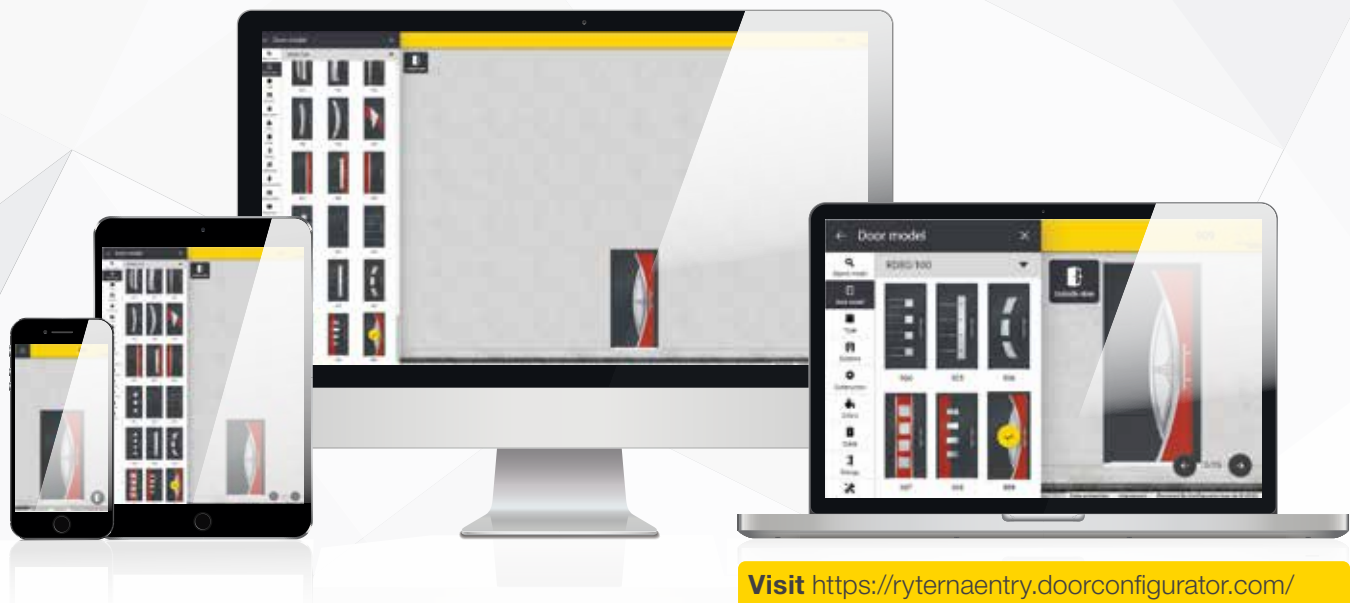

Visit <https://ryternaentry.doorconfigurator.com/>



Design **706**
Model **RD100**
Outside colour **RAL7016**
Handle **H90S40B-800**
Escutcheon **ESC-3**
Glazing **Etched effect**
Applique **Inlaid stainless metal**
Decor **Carving**

release date:
28.07.2020

www.ryternaentry.com
<https://ryternaentry.doorconfigurator.com>